

Fig. 1

Fig. 2

保留規格修改的權利
Subject to technical changes

外型尺寸 DIMENSIONS

型號 MODEL	H-1	H-2	H-3	H-4	H-5	H-6	H-7	H-8	H-9	H-10	H-11	H-12	H-13	排齒節距 Serration Pitch	適用夾頭 Matching Chuck	三爪重量 3 Jaw Weight kg	參考圖 Reference Drawing
HJ-06	67	31	36	12	5	38.5	20	28.5	11	17	12	M10	10	1.5×60°	3H-206, 3P-06	1.7	Fig.2
HJ-08	87	35	51	14	5	32	25	18	13	19	12	M12	12	1.5×60°	3H-208, 3P-08	2	Fig.1
HJ-10	102	40	54	16	5	39	30	23	13	19	13	M12	16	1.5×60°	3H-210, 3P-10	3	Fig.1
HJ-12H	103	50	52	21	5	62.5	30	40.5	17	25	17	M16	30	1.5×60°	3H-12, 3H-212, 3L-212, 3V-12, 3P-12, 3M-12	3.5	Fig.2
HJ-12P	103	50	52	18	5	62.5	30	40.5	15	22	17	M14	30	1.5×60°	3P-12	3.6	Fig.2
HJ-15H	149	62	86	22	8	63	43	34	21	32	20	M20	43	1.5×60°	3H-15, 3H-215, 3H-18, 3V-15, 3V-18	9.6	Fig.1
HJ-15P	149	62	86	25.5	6	63	43	34	21	32	20	M20	43	1.5×60°	3H-15, 3H-215, 3H-18, 3P-215, 3P-218	9.5	Fig.1
HJ-21	159.5	80	90	25	9	104.5	50	55	21	32	40	M20	55	3.0×60°	3H-221, 3H-224, 3H-232, 3P-221, 3P-224, 3V-21, 3V-24, 3V-32	14.3	Fig.2

3MF 標準硬爪

STANDARD HARDENED JAW FOR 3MF CHUCK

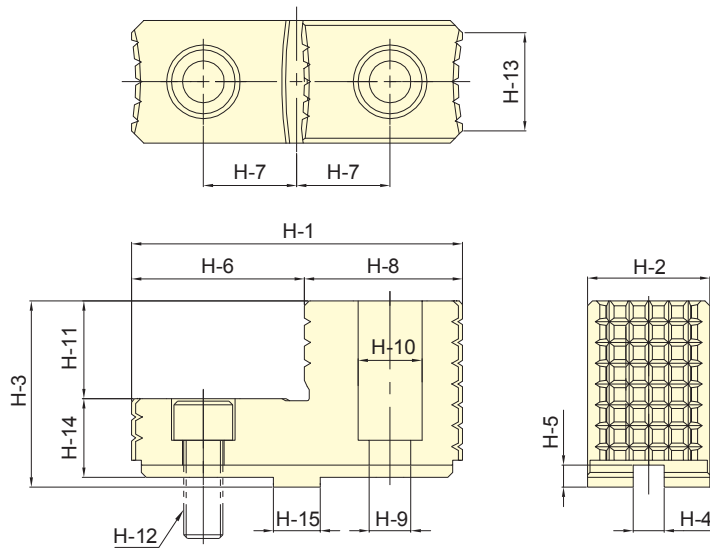

保留規格修改的權利 Subject to technical changes

外型尺寸 DIMENSIONS

型號 Model	H-1	H-2	H-3	H-4	H-5	H-6	H-7	H-8	H-9	H-10	H-11	H-12	H-13	H-14	H-15	適用夾頭	三爪重量 (kg)
																Matching Chuck	3 Jaw Weight
3MF-20	135	50	76	12.7	9	70	38.1	65	17	26	40	M16	40	32	19.03	3MF-20	6.7